

# Instructions for preparing an ACU-Drop® II sample

## Instruction A - Sampling with Dropper Tip

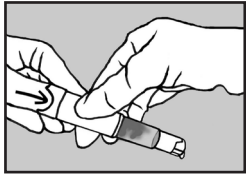

**A1** - Press the button firmly until it is completely pushed in and level with the indentation.

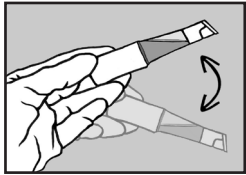

**A2** - Gently rock and swirl at least 5 times to mix the content completely.

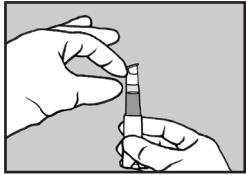

**A3** - Hold the ACU-Drop II with cap facing up and flick the cap firmly several times to make sure that no liquid remains inside the dropper tip.

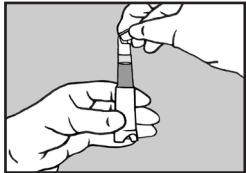

**A4** - Open the flip cap very carefully by lifting the cap just a little bit to release the pressure.

**-Only with first time use-**

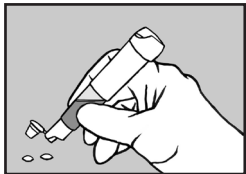

**A5** - The first 2 drops should be dispensed and discarded.



**A6** - The ACU-Drop II is now ready to use to apply a sample drop for testing.

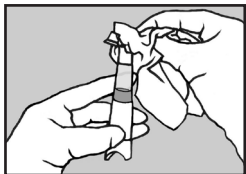

**A7** - After each use, be sure to wipe the dropper tip and inside of cap to keep them clean.

## Instruction B - Sampling with Syringe

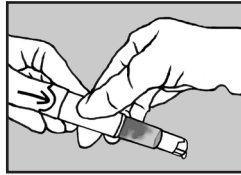

**B1** - Press the button firmly until it is completely pushed in and level with the indentation.

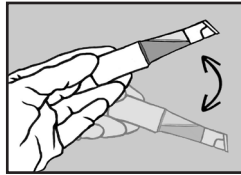

**B2** - Gently rock and swirl at least 5 times to mix the content completely.

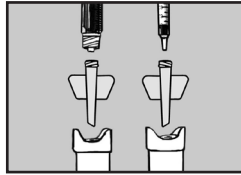

**B3** - Twist the adaptor onto the tip of either a luer lock or standard syringe.

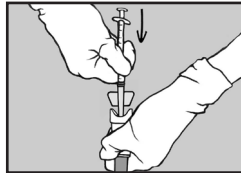

**B4** - Hold the ACU-Drop II with cap facing down and flick the bottom firmly several times to be sure that all the liquid settles. Push the adaptor tip attached to the syringe firmly into the luer fitting on the button of the ACU-Drop II.

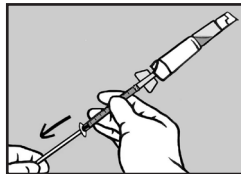

**B5** - Hold the ACU-Drop II with cap facing up and, using both hands on the syringe, withdraw the contents.

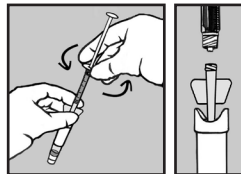

**B6** - Hold the adaptor with the ACU-Drop II cap facing down and carefully unscrew the syringe, leaving the adaptor in the button of the ACU-Drop II.



**B7** - Discard the ACU-Drop II with the adaptor and use the syringe to deliver your sample.

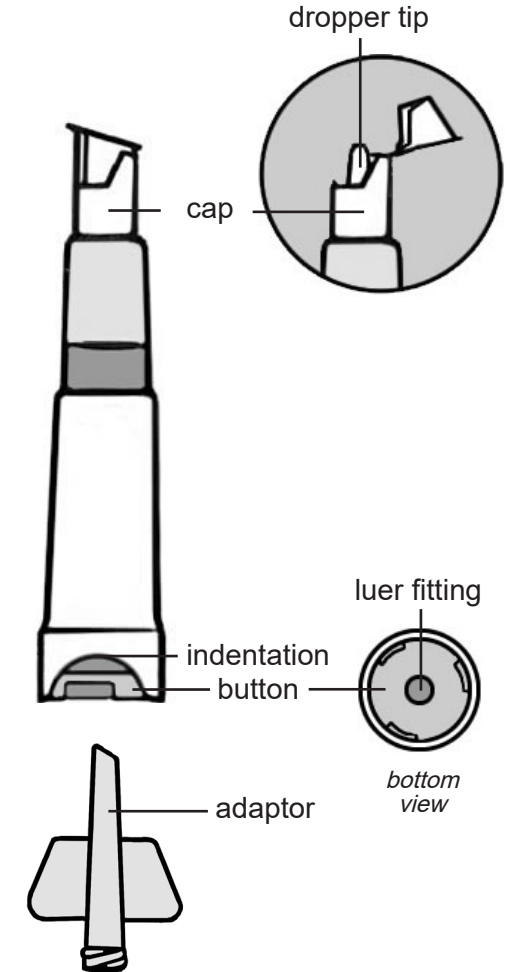

For instructional video go to [www.eurotrol.com/acudrop2](http://www.eurotrol.com/acudrop2)

